

# Yufeng 180a generator idling charging

114KWh ESS



PICC  
MULTI-RISKS

RoHS



MSDS

UN38.3

UK  
CA



## Yufeng 180a generator idling charging

---



### How to Fix a Surging Generator: 7 Expert Tips to ...

Discover effective steps to fix a surging generator and restore power with our expert tips and practical solutions.

[Get Price](#)

### [Solved] Why is My Generator Surging (Revving Up and Down)?

This can happen when the generator is under load or when it's simply at idle. As a general rule, a portable generator will surge at idle due to a clogged or restricted pilot jet on the carburetor.

[Get Price](#)



### Why Is My Generator Surging? Causes & How to Fix It

Why is my generator surging? Discover the common causes and learn how to fix a surging generator with our simple troubleshooting guide.

[Get Price](#)



### Generator Idle Control Not Working: Common Causes And Effective ...

Struggling with generator idle control issues? Our comprehensive article unveils common causes, from mechanical failures to electrical glitches, and provides actionable solutions for ...

[Get Price](#)

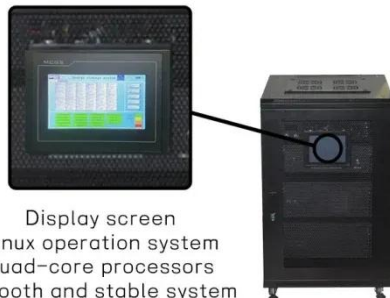
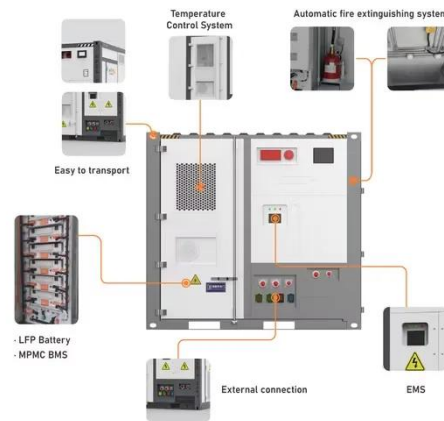

Display screen  
Linux operation system  
quad-core processors  
smooth and stable system

### Generator Surging at Idle: Causes, Troubleshooting, and Solutions

A faulty or improperly adjusted governor causes irregular throttle responses at idle, creating surging. Testing the governor's components and linkage, then recalibrating or repairing, will ...

[Get Price](#)

### Generator Auto Idle Not Working? Troubleshooting Tips to Fix the ...

Is your generator's auto idle feature failing? Discover the common causes of this frustrating issue and learn practical troubleshooting steps to restore efficiency.

[Get Price](#)



### Why Does My Generator Idle Up and Down?

Maintenance can prevent issues at idling, and it can also solve some problems that can cause your generator to idle up and down: Start by checking

the fuel level and adding more fuel if needed.

[Get Price](#)



---

## battery charging

When the generator turns on and is running idle, the frequency reading on the generator with no wires or loads, between L1-L2 is 180 Hz or more, frequency reading between L1-N, L2-N, L2 ...

[Get Price](#)



---

## Generator Idle Control Not Working - 101 Generator

When the generator idle control is not working, it can lead to increased fuel consumption, engine overheating, and excessive noise. This article explores the common causes of idle control ...

[Get Price](#)



---

## Generator Surging While Not Under Load? Here's Why

If your generator is surging while not under load, it could be due to a clogged fuel filter, using the wrong fuel, low oil, dirty idle jet, or contaminated fuel. Easy

fixes include cleaning or ...

[Get Price](#)



### **[Solved] Why is My Generator Surging (Revving Up and Down)?**

Is your generator's auto idle feature failing? Discover the common causes of this frustrating issue and learn practical troubleshooting steps to restore efficiency.

[Get Price](#)

## **Contact Us**

For catalog requests, pricing, or partnerships, please visit:  
<https://www.k3gizycko.pl>

